

Ratio 1:1 Flow rate 23 l/min

Ratio 1:1 Flow rate 40 l/min

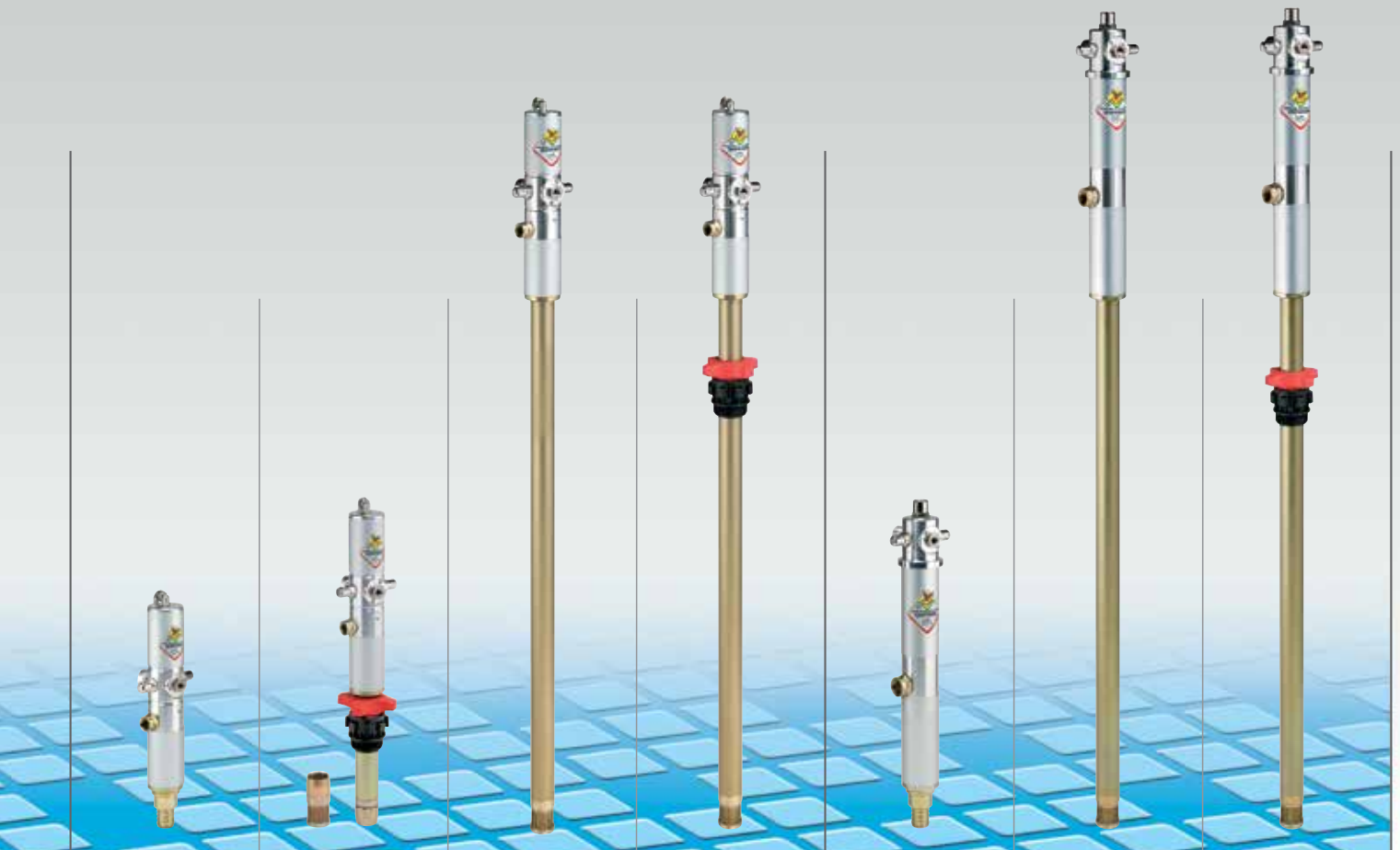

series 600

serie 650

33080
33070
33060

33081
33071
33061

33082
33072
33094

33083
33073
33096

33170
33160

33172
33194

33173
33196

Oils, lubricants and similar
Aluminium
Carbon steel

Oils, lubricants and similar
Aluminium
Carbon steel

F 1/4" G
F 1/2" G
6 - 8
230
81
80

F 1/4" G
F 1/2" G
6 - 8
230
81
80

F 1/4" G
F 1/2" G
6 - 8
230
81
80

F 1/4" G
F 1/2" G
6 - 8
230
81
80

F 1/4" G
F 3/4" G
6 - 8
370
81
130

F 1/4" G
F 3/4" G
6 - 8
370
81
130

F 1/4" G
F 3/4" G
6 - 8
370
81
130

standard

standard

standard

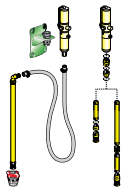

modular

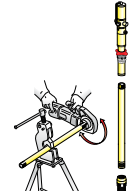

customisable 1"



suitable for drums
180-220 Kg



suitable for drums
180-220 Kg

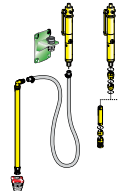

modular



suitable for drums
180-220 Kg

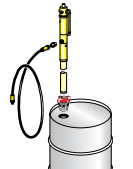

suitable for drums
180-220 Kg

1 - 0,006
4,3

1 - 0,006
5

1 - 0,020
6,2

1 - 0,020
6,3

1 - 0,010
5,3

1 - 0,020
7,3

1 - 0,020
7,4

35,5 - 0 - 0

35,5 - 22 - 4,2

35,5 - 94 - 4,2

35,5 - 94 - 4,2

50,5 - 0 - 0

50,5 - 94 - 4,2

50,5 - 94 - 4,2

